

БГ-6500Э

| NO. | DESCRIPTION | NO. | DESCRIPTION |
|-----|-------------------------|-----|------------------------------|
| 1 | FUEL TANK CAP | 47 | ELECTRIC STARTING SWITCH |
| 2 | FILTER SCREEN | 48 | ELECTRIC STARTING SWITCH KEY |
| 3 | FUEL GAUGE (INDICATOR) | 49 | 2A FUSE |
| 4 | HEX. FLANGE BOLT | 50 | NUT |
| 5 | FLAT WASHER | 51 | FLAT WASHER |
| 6 | BUSH | 52 | SPRING WASHER |
| 7 | FUEL TANK CUSHION | 53 | VOLTMETER ASSEMBLY |
| 8 | FUEL TANK | 54 | CROSS HEAD BOLT |
| 9 | FUEL TANK SWITCH | 55 | BREAKER |
| 10 | ENGINE | 56 | CROSS HEAD BOLT |
| 11 | AIR FILTER BRACKET | 57 | FLAT WASHER |
| 12 | NUT | 58 | EURO STYLE SOCKET |
| 13 | MUFFLER ASSEMBLY | 59 | SOCKET CUSHION |
| 14 | HEX. FLANGE BOLT | 60 | TERMINAL |
| 15 | MUFFLER SIDE COVER | 61 | NUT |
| 16 | HEX. FLANGE BOLT | 62 | SPRING WASHER |
| 17 | HEX. FLANGE BOLT | 63 | FLAT WASHER |
| 18 | MUFFLER SUPPORT BRACKET | 64 | HEX. FLANGE BOLT |
| 19 | MOTOR BACK COVER | 65 | FUSE |
| 20 | ROTOR | 66 | PANEL |
| 21 | STATOR WINDING | 67 | HEX. FLANGE BOLT |
| 22 | MOTOR BRACKET | 68 | PROTECTOR |
| 23 | NUT | 69 | PANEL REAR COVER |
| 24 | SPRING WASHER | 70 | HEX. FLANGE BOLT |
| 25 | HEX. FLANGE BOLT | 71 | BATTERY BOX |
| 26 | CARBON BRUSH ASSEMBLY | 72 | BATTERY |
| 27 | HEX. FLANGE BOLT | 73 | NUT |
| 28 | RECTIFIER | 74 | SMALL CUSHION PAD |
| 29 | HEX. FLANGE BOLT | 75 | FLAT WASHER |
| 30 | CONNECTION BLOCK | 76 | SPRING WASHER |
| 31 | HEX. FLANGE BOLT | 81 | NUT |
| 32 | AVR | 82 | RUBBER FOOT PAD |
| 33 | FLAT WASHER | 83 | BIG CUSHION PAD |
| 34 | SPRING WASHER | 88 | CONNECTION WIRE OF BATTERY |
| 35 | HEX. FLANGE BOLT | | |
| 36 | HEX. FLANGE BOLT | | |
| 37 | REAR COVER | | |
| 38 | HEX. FLANGE BOLT | | |
| 39 | HEX. FLANGE BOLT | | |
| 40 | COLLAPSIBLE BEAM | | |
| 41 | FLAME | | |
| 42N | GUARD BOARD | | |
| 43N | GUARD BOARD | | |

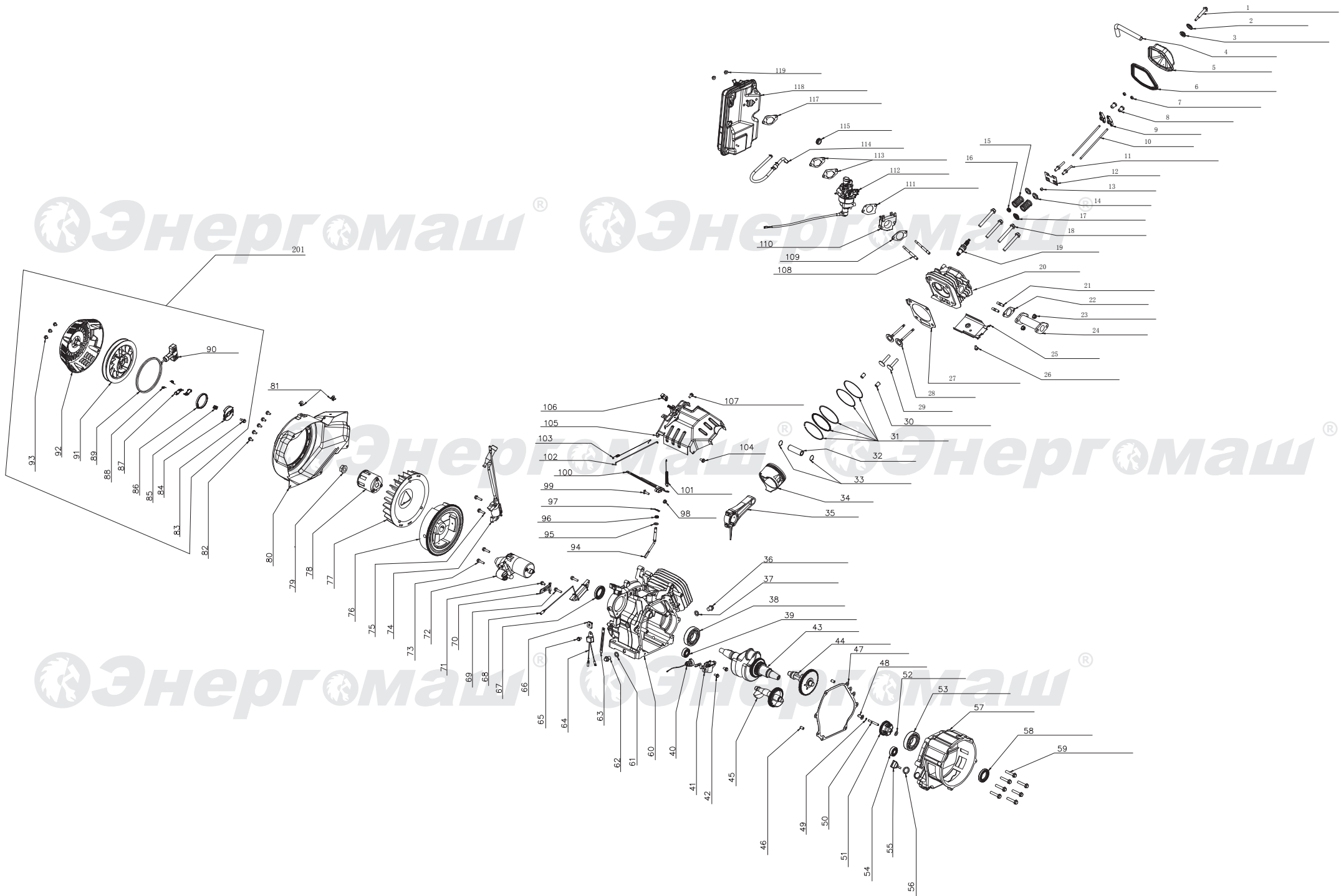

ЭЛЕКТРОДВИГАТЕЛЬ ДЛЯ БГ-6500Э

| NO. | DESCRIPTION | NO. | DESCRIPTION | NO. | DESCRIPTION |
|-----|-------------------------------|-----|-----------------------------------|-----|---------------------------|
| 1 | ASSEMBLING BOLT | 41 | OIL SENSOR ASSEMBLY | 81 | SWALLOW CLAMP |
| 2 | SEALED CAP | 42 | HEX. FLANGE BOLT | 82 | HEX. FLANGE BOLT |
| 3 | BOLT SEAL | 43 | CRANK ASSEMBLY | 83 | PRESSURE BOARD SCREW |
| 4 | WASTE PIPE | 44 | CAMSHAFT ASSEMBLY | 84 | PRESSURE BOARD |
| 5 | CYLINDER HEAD COMP | 45 | BALANCE SHAFT | 85 | PRESSURE BOARD SPRING |
| 6 | CYLINDER HEAD SEAL | 46 | CRANKCASE COVER POSITION PIN | 86 | SPRING |
| 7 | VALVE CLEARANCE ADJUSTING NUT | 47 | CRANKCASE PAPER WASHER | 87 | RATCHET |
| 8 | VALVE ARM NUT | 48 | SPEED ADJUSTING SHAFT SLEEVE | 88 | RATCHET SPRING |
| 9 | VALVE ARM | 49 | CIRCLIP FOR SPEED ADJUSTING SHAFT | 89 | PULLING CORD |
| 10 | LEVER | 50 | SPEED ADJUSTING SHAFT | 90 | HANDLE |
| 11 | SCREW | 51 | SPEED GEAR ASSY | 91 | RECOIL STARTER REEL |
| 12 | LEVER BRACKET | 52 | WASHER | 92 | REEL COVER |
| 13 | VALVE HEAD CAP | 53 | DEEP GROOVE BALL BEARING 6207 | 93 | HEX. FLANGE BOLT |
| 14 | VALVE SPRING BASE | 54 | DEEP GROOVE BALL BEARING 6202 | 94 | GOVERNOR ROD |
| 15 | VALVE SPRING | 55 | OIL LEVEL CAP ASSEMBLY | 95 | WASHER |
| 16 | VALVE SEAL | 56 | OIL LEVEL SEAL | 96 | OIL SEAL FOR GOVERNOR ROD |
| 17 | VALVE SPRING DOWN BASE | 57 | CRANKCASE HIGH COVER | 97 | CLAMP FOR GOVERNOR ROD |
| 18 | CYLINDER BOLT | 58 | OIL SEAL | 98 | NUT |
| 19 | SPARK PLUG | 59 | HEX. FLANGE BOLT | 99 | T SHAPED BOLT |
| 20 | CYLINDER HEAD | 60 | CRANKCASE | 100 | GOVERNOR ARM |
| 21 | STUD BOLT | 61 | WASHER | 101 | RESET SPRING |
| 22 | MUFFLER GASKET | 62 | OIL DRAIN BOLT | 102 | GOVERNOR BAR |
| 23 | SELF-LOCKING HEX. FLANGE NUT | 63 | CORD CLAMP I | 103 | TRIMMING SPEED SPRING |
| 24 | MUFFLER SIPHONIUM | 64 | ONE-WAY CONDUCTOR ASSY | 104 | HEX. FLANGE BOLT |
| 25 | DOWN WIND GUARD | 65 | HEX. FLANGE BOLT | 105 | GOVERNOR BASE ASSY |
| 26 | HEX. FLANGE BOLT | 66 | CRANKCASE RUBBER RING | 106 | CORD CLAMP |
| 27 | CYLINDER HEAD SEAL GASKET | 67 | OIL SEAL | 107 | HEX. FLANGE BOLT |
| 28 | INTAKE AND EXHAUST VALVE | 68 | CHARGE COIL ASSY | 108 | STUD SCREW |
| 29 | LITER | 69 | HEX. FLANGE BOLT | 109 | INTAKE WASHER |
| 30 | VALVE HEAD POSITION PIN | 70 | PRESSURE BOARD | 110 | CARBURETOR HEAT INSULATOR |
| 31 | PISTON RING ASSY | 71 | HEX. FLANGE BOLT | 111 | (OUT) CARBURETOR WASHER |
| 32 | PISTON PIN | 72 | MOTOR | 112 | CARBURETOR ASSEMBLY |
| 33 | PISTON CIRCLIP | 73 | HEX. FLANGE BOLT | 113 | (IN) CARBURETOR WASHER |
| 34 | PISTON | 74 | IGNITION COIL ASSY | 114 | CHECK VALVE |
| 35 | CONNECTION ROD | 75 | HEX. FLANGE BOLT | 115 | SCREW RUBBER RING |
| 36 | OIL DRAIN BOLT | 76 | FLY WHEEL WITH GEAR | 117 | CARBURETOR WASHER |
| 37 | WASHER | 77 | FAN | 118 | AIR FILTER ASSEMBLY |
| 38 | DEEP GROOVE BALL BEARING 6207 | 78 | START COVER | 119 | NUT |
| 39 | DEEP GROOVE BALL BEARING 6202 | 79 | NUT | 201 | RECOIL STARTER |
| 40 | NUT | 80 | FAN COVER | | |